



1 Hart Street

, Wallingford, OX10 0FX

Guide price £350,000



A Rare opportunity for a modern built 2 bedroom house with south facing garden and parking, situated in Wallingford town centre.



Description

Entry off Hart Street into the open plan Living, Kitchen, Dining room with understairs storage and cloakroom. French doors lead to the rear.

Upstairs leads to:

Main bedroom to the rear with built in wardrobes

Second bedroom to the front

Bathroom with shower over bath, WC and basin

Outside to the south facing rear patio terrace, walled to one side.

Gate to rear passage way

Parking for one car

Underfloor heating downstairs

Electric heating

Wallingford town centre is just around the corner, with its popular market place and local shops, café's, bars and restaurants along with Waitrose and nearby Lidl. Wallingford is located within easy access to the M4, M40 and A34, Harwell campus and mainline stations can be found at nearby Cholsey & Didcot.

Area Map

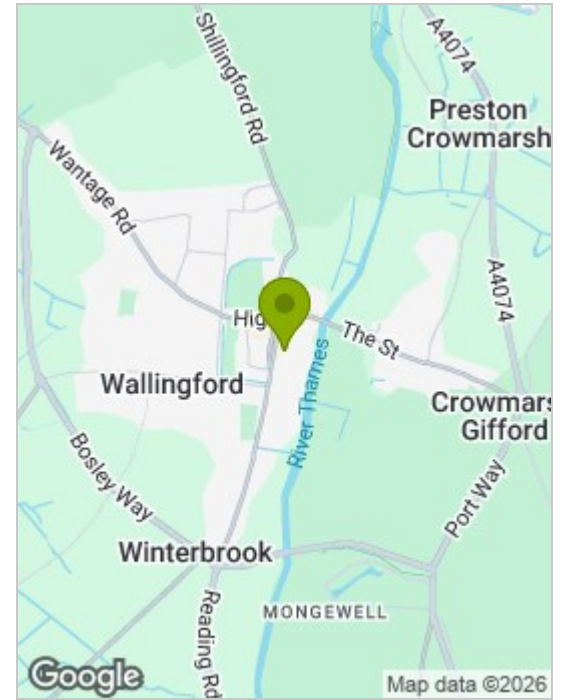

Floor Plans

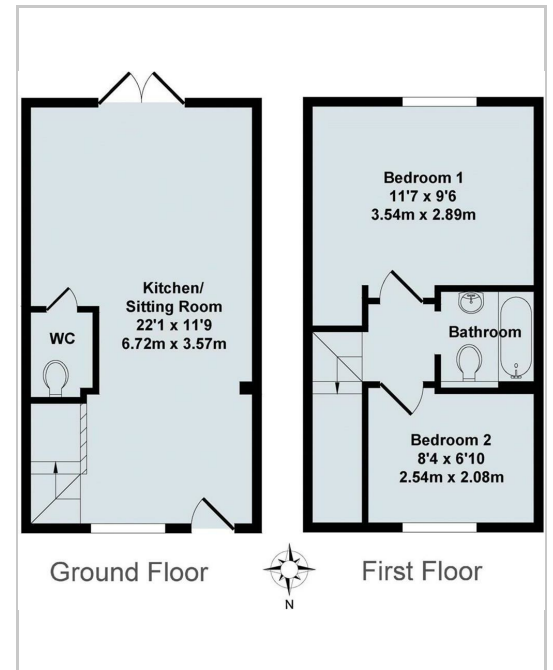

Energy Efficiency Graph

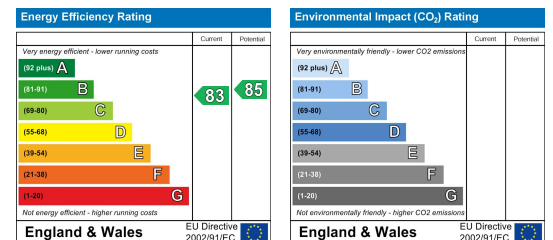

These particulars, whilst believed to be accurate are set out as a general outline only for guidance and do not constitute any part of an offer or contract. Intending purchasers should not rely on them as statements of representation of fact, but must satisfy themselves by inspection or otherwise as to their accuracy. No person in this firm's employment has the authority to make or give any representation or warranty in respect of the property.